

1 BC East Elevation
1:200

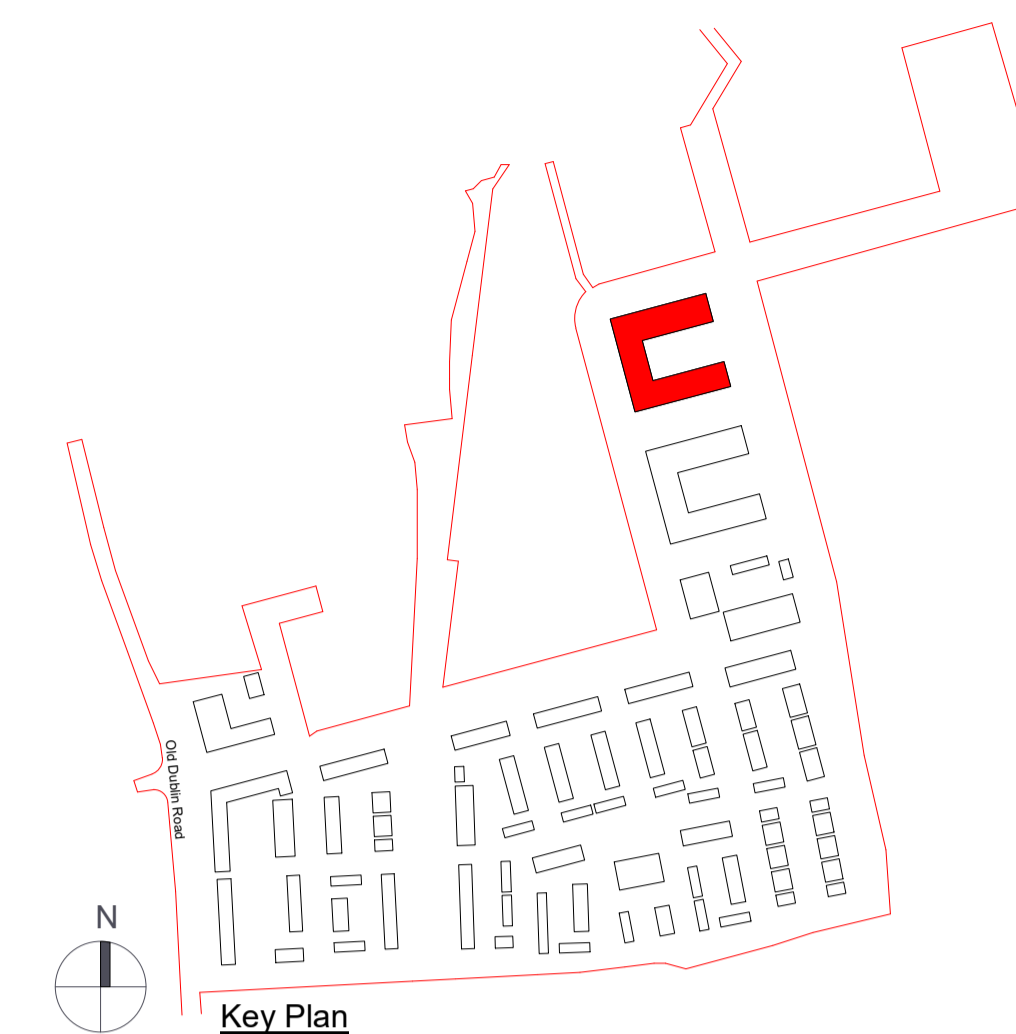

2 BC West Elevation
1:200



- 1 Brick Type A
- 2 Brick Type B
- 3 Brick Type C
- 4 Pre-Cast Frame Type A
- 5 Pre-Cast Frame Type B
- 6 Selected Render
- 7 Selected Contrasting Render
- 8 Metal Balustrade
- 9 Double Glazed Window System with Spandrel Panel
- 10 Selected Sedum Roof
- 11 Selected Metal Ventilation Grille

All levels (in meters) are related to Malin head datum.
All dimensions in millimeters.
Figured dimensions only are to be taken from this drawing.

Revision Description	Date	Rev. No.	Issued by
Issued for Planning	09.10.2019	1	TT

Figured dimensions only to be used. This drawing is copyright of O'Mahony Pike Architects Ltd. All information is shared as per approved use in accordance with BS1192(2007) + A2(2016), Table 5; Standard Codes for Suitability of Models and Documents. If the 'Status' field is empty, this information has been shared at S0 - WIP.

omahony pike Project No.: 1618 Scale @ A1: 1:200
 architecture | urban design Dublin Cork
 email: info@omahonypike.com The Chapel 26 South Mall
 tel: +353 1 202 7400 Mount St. Anne's Cork City
 fax: +353 1 283 0822 Milltown, Dublin 6 Co. Cork
 www.omahonypike.com D06 XN52 Ireland T12 R2RV Ireland

Drawn By: TT **Current Rev.:** 1 **Status:** S0
Model No.: 1618-OMP-00-M3-A-0001 **Purpose:** Planning

Project: Woodbrook Phase 1
Location: Woodbrook
Client: Aeval

Drawing Title: Block C - East and West Elevations
Drawing No.: 1618-OMP-BC-ZZ-DR-A-21001